

SPECIFICATIONS:
 VALVE BODY - BRASS
 SEAT PLUG - ALUMINUM SILICON
 BRONZE W/ KEL-F SEAT
 BONNET - BRASS, W/ VG-109 VITON
 & TEFLON SEALS, AND NYLATRON
 THRUST WASHER
 STEM - BRASS
 SEAL RING - TEFLON COATED STAINLESS STEEL
 MAXIMUM VALVE BODY OPERATING PRESSURE 5000 PSI @ 70 F
 Cv FACTOR - 3.1

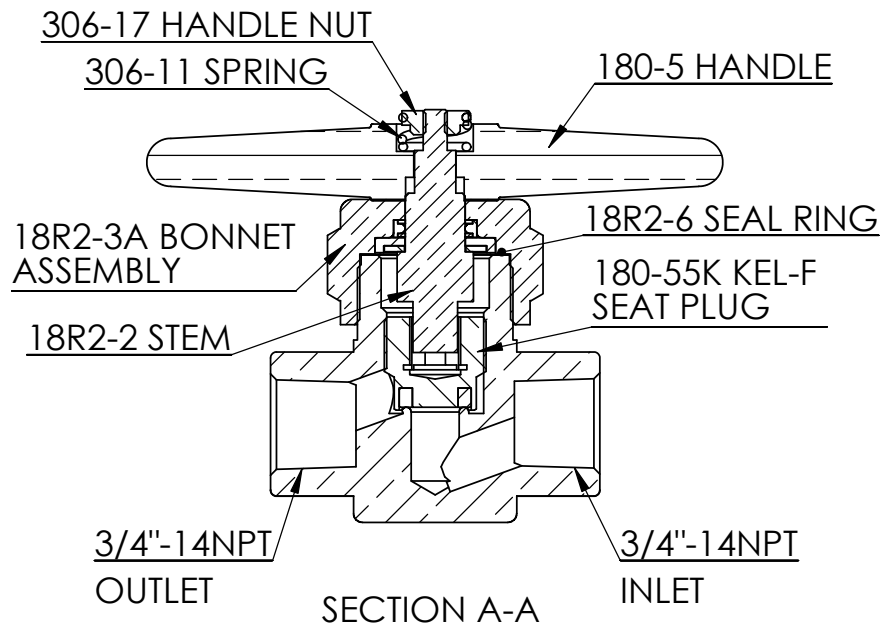
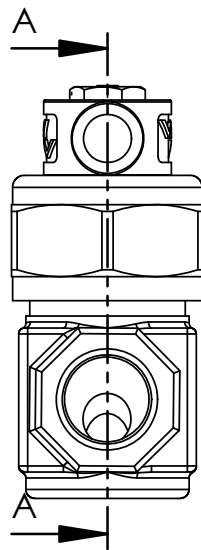

PROPRIETARY AND CONFIDENTIAL
 THE INFORMATION CONTAINED IN THIS
 DRAWING IS THE SOLE PROPERTY OF
 WESTERN VALVE. ANY REPRODUCTION
 IN PART OR AS A WHOLE WITHOUT
 THE WRITTEN PERMISSION OF
 WESTERN VALVE IS PROHIBITED.

#	REVISIONS	DATE	BY

NAME	DATE
DCH	0/19/16
CHECKED	
ENG APPR.	
MFG APPR.	
Q.A.	
COMMENTS:	

WESTERN VALVE	
MASTER VALVE 3/4"NPT X 3/4"NPT	
SIZE A	DWG. NO. 18R2E
SCALE:1:2	WEIGHT:
SHEET 1 OF 1	